

ADJUSTMENT

The right and left support assemblies are slotted to allow for right/left drive train adjustment in relation to drive shaft assembly length.

Check and reposition right and left engine support assemblies as required. Adjust drive train position, if required, for the following conditions:

- | Drive shaft distress: See Group 2, Suspension and Driveshaft.
- | Any front end structural damage (after repair).
- | Support Assembly replacement.

ENGINE SUPPORT ADJUSTMENT

1. Remove the load on the engine motor mounts by carefully supporting the engine and transmission assembly with a floor jack.
2. Loosen the right engine support assembly vertical fasteners.
3. Loosen the left engine support assembly vertical bolts.
4. Pry the engine right or left as required to achieve the proper drive shaft assembly length. Refer to Group 2, Suspension and Driveshaft for driveshaft identification and related assembly length measuring.
5. Tighten right engine support assembly vertical bolts to 61 N·m (45 ft. lbs.) and tighten left engine support assembly bolts to 61 N·m (45 ft. lbs.).
6. Recheck drive shaft length.

REMOVAL

1. Raise vehicle.
2. Remove the belly pan (2).

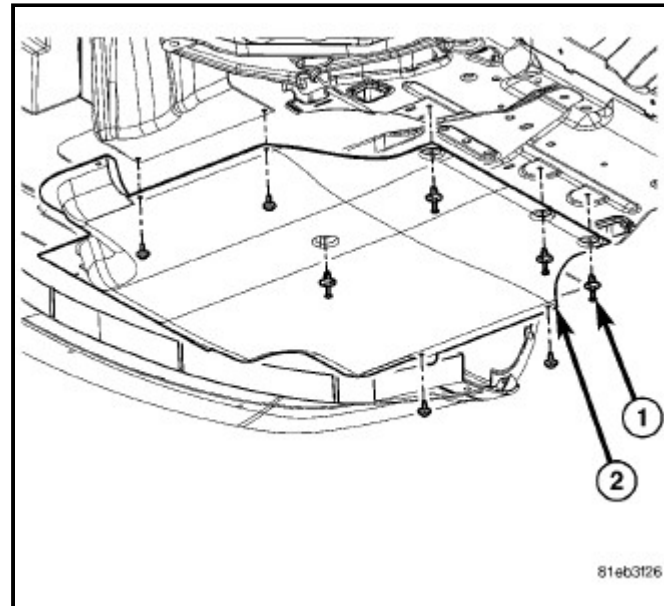

3. Remove front mount to bracket horizontal through bolt (2).

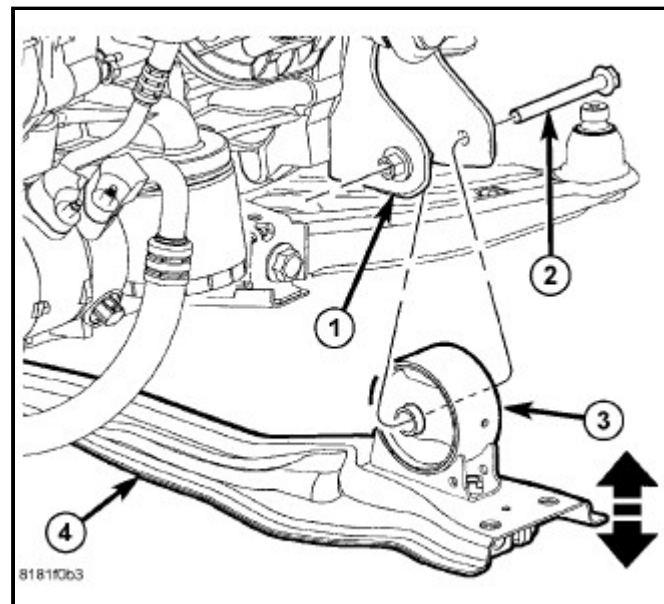

4. Remove front mount vertical bolts (2).
5. Remove front mount (3).

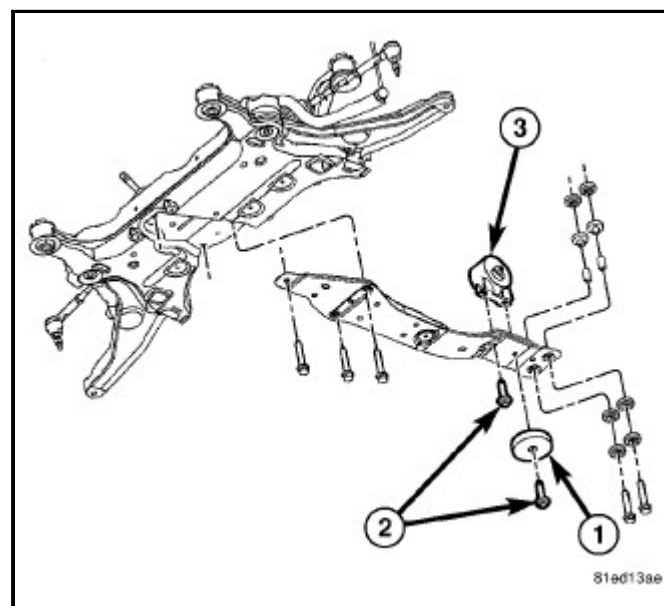

INSTALLATION

1. Install the front mount (3).

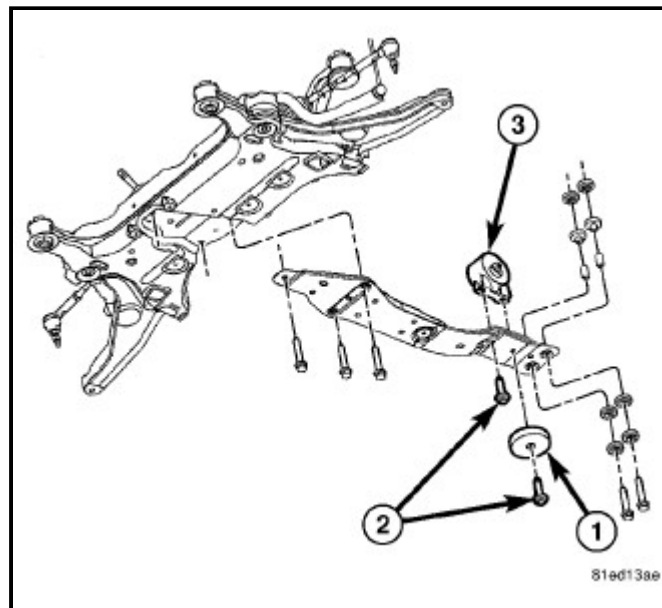

2. Install the front mount vertical bolts (2).

3. Install the front mount to bracket horizontal through bolt (2).

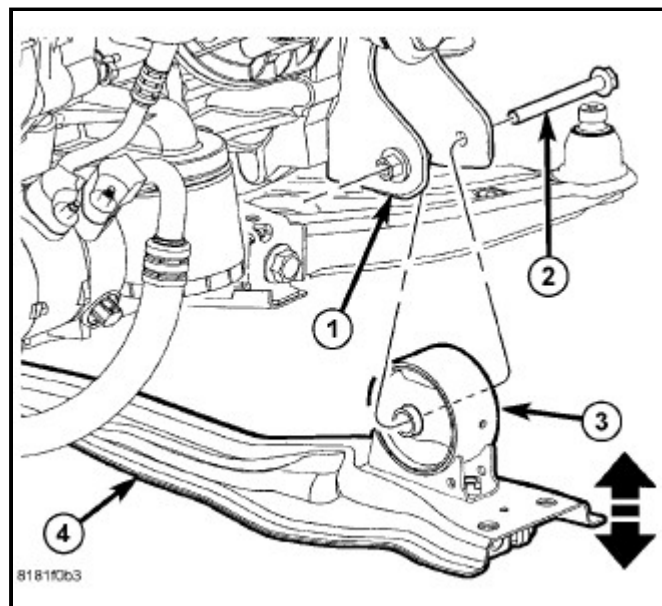

4. Install the belly pan (2).

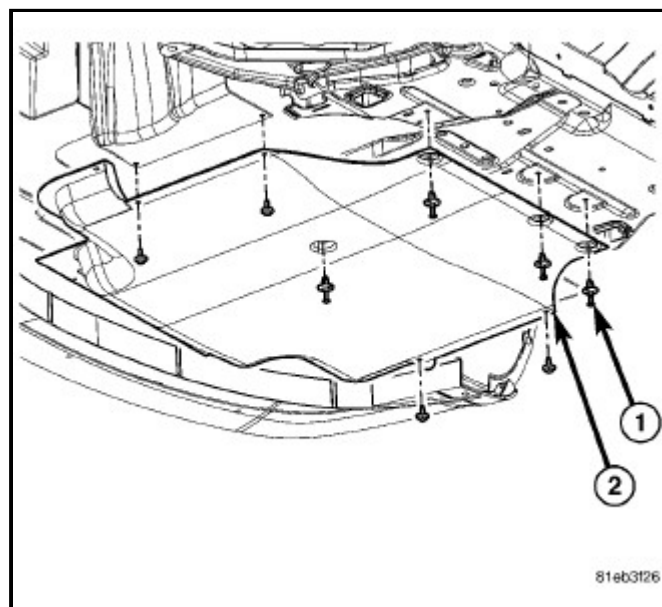

REMOVAL

1. Disconnect and isolate the negative battery cable.
2. Remove throttle body air inlet hose and air cleaner housing assembly ([Refer to 09 - Engine/Air Intake System/BODY, Air Cleaner - Removal](#)).
3. Remove the belly pan (2).

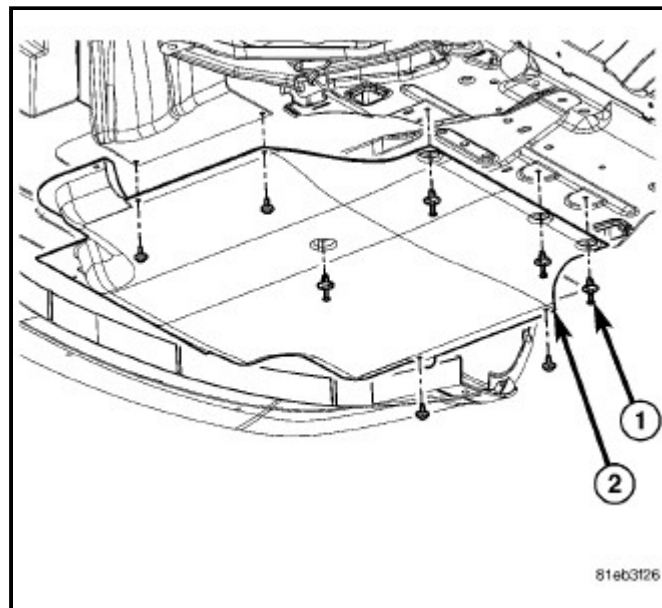

4. Support transmission with floor jack and wooden block.
5. Remove the vertical bolts (1) from the left mount (2) to transmission bracket.

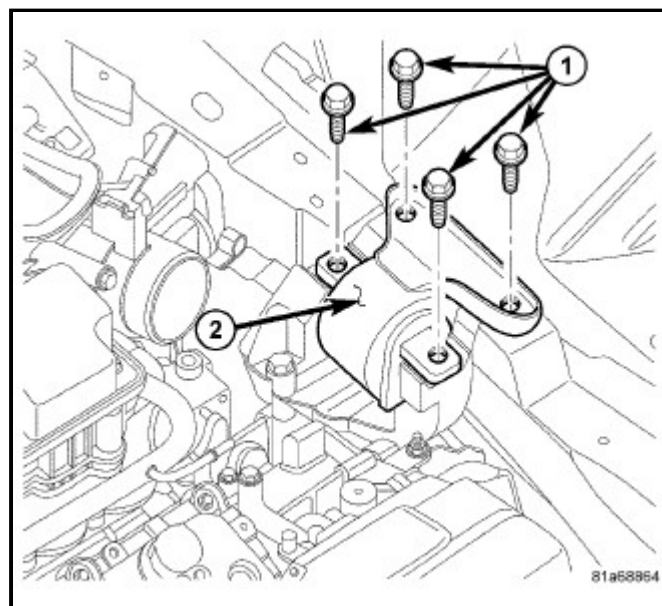

6. Slightly lower transmission with floor jack to gain access to mount to frame rail fastener (2).
7. Remove mount isolator (3).

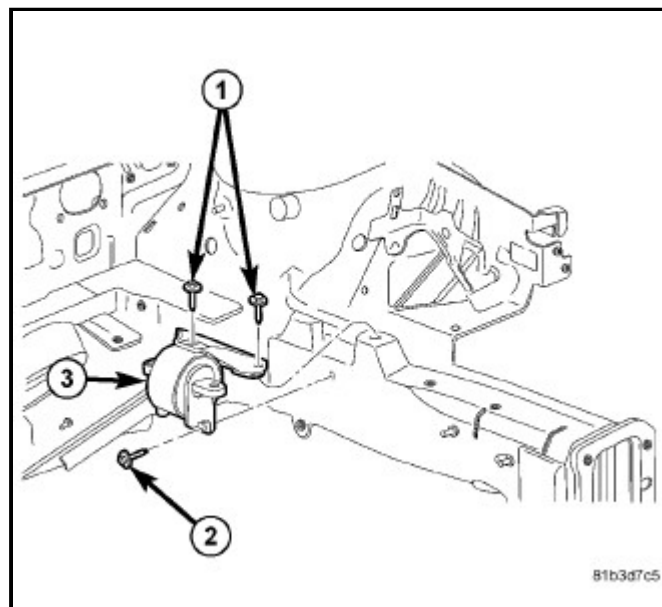

INSTALLATION

1. Position mount isolator (3) in place, install bolts (1, 2) and tighten to 50 N·m (37 ft. lbs.).

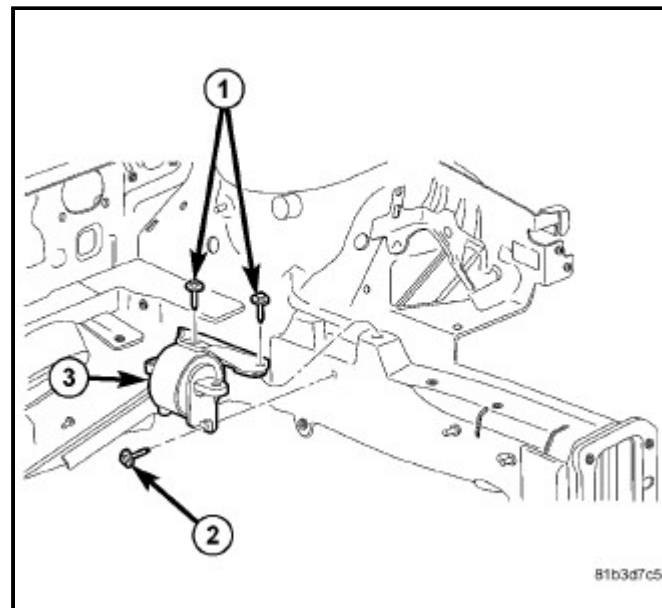

2. Raise transaxle into position, install bolts (2) and tighten to 98 N·m (72 ft. lbs.).
3. Remove floor jack and wooden block.

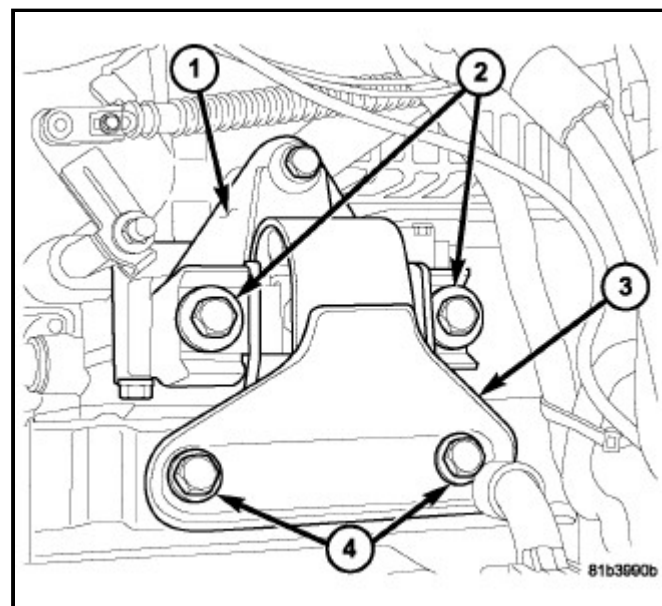

4. Install belly pan (2).
5. Install throttle body air inlet hose and air cleaner housing assembly ([Refer to 09 - Engine/Air Intake System/BODY. Air Cleaner - Installation](#)).
6. Connect negative battery cable.

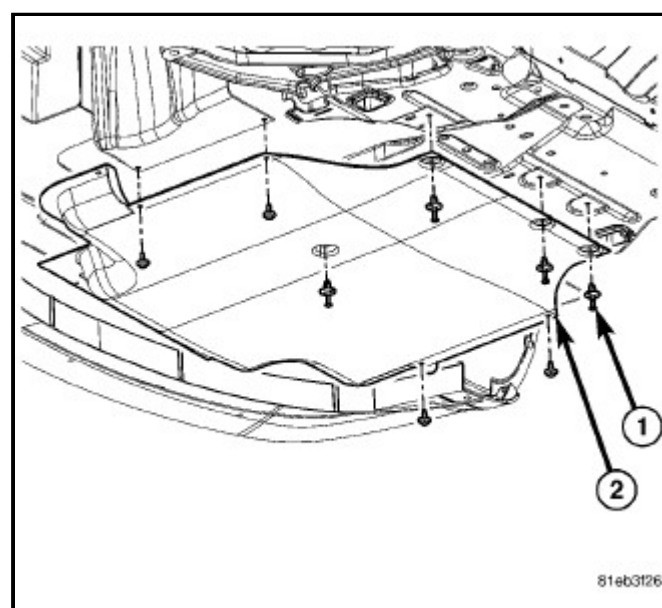

REMOVAL

1. Remove throttle body air inlet hose and air cleaner housing assembly ([Refer to 09 - Engine/Air Intake System/BODY, Air Cleaner - Removal](#)).
2. Raise the vehicle.
3. Remove the belly pan (2).

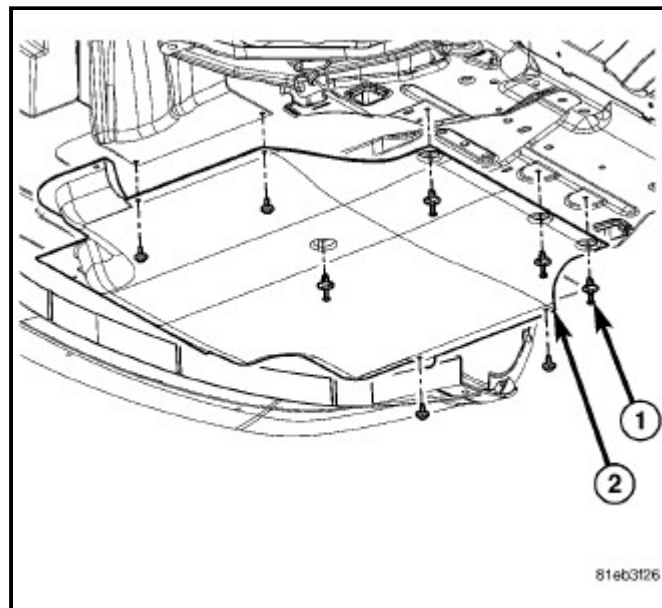

4. Remove three vertical bolts (1) attaching rear mount bracket to transaxle case.

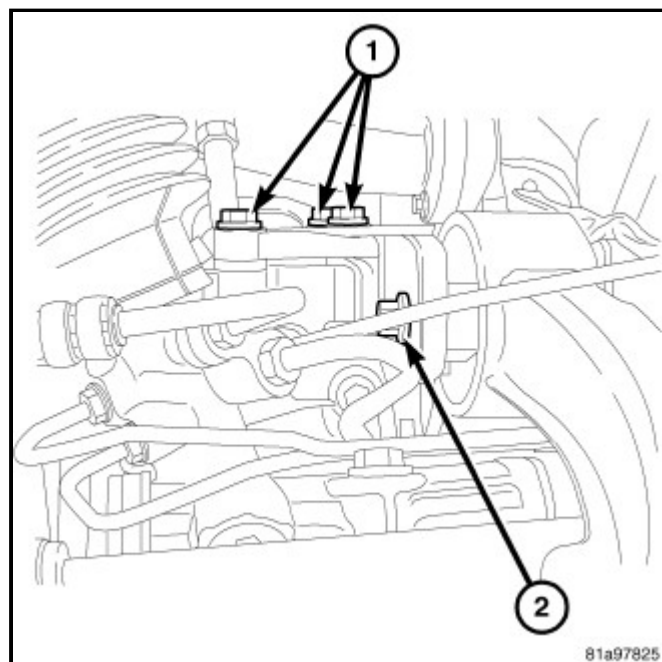

5. Loosen the front mount through bolt (2).

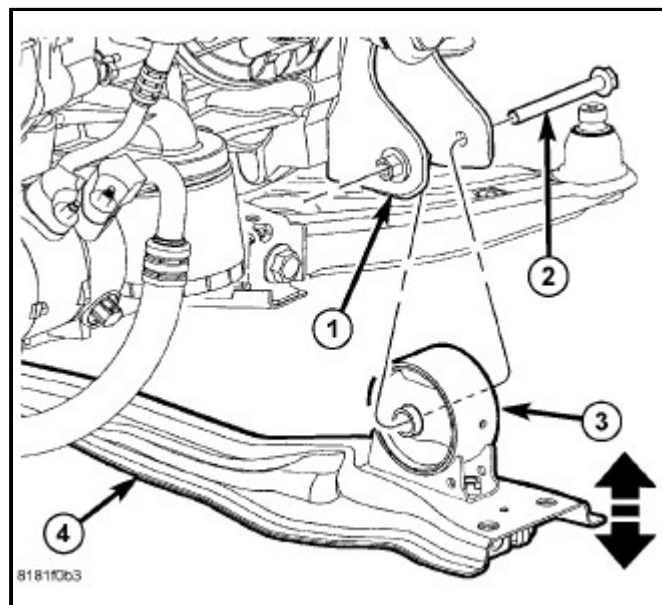

6. Remove rear mount bracket through bolt (1).

7. Remove rear mount bracket from transaxle case.
8. Remove rear isolator to suspension crossmember attaching bolts.
9. Remove rear isolator (2).

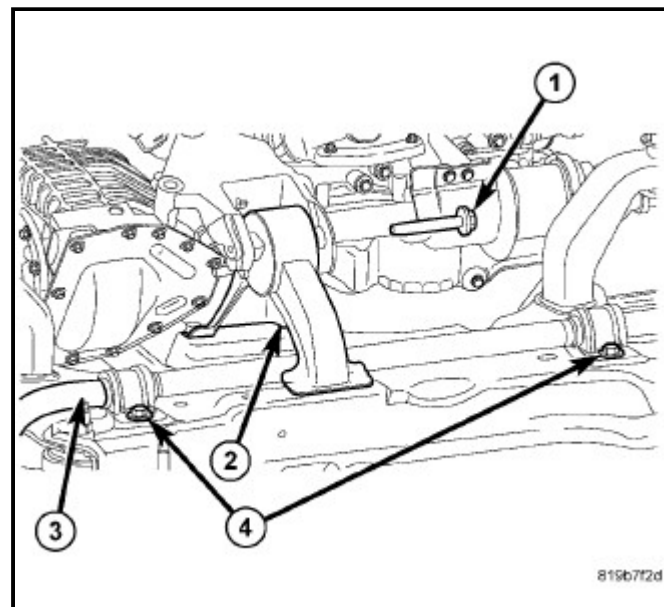

INSTALLATION

1. Position rear isolator (2) on suspension crossmember and loosely install bolts.

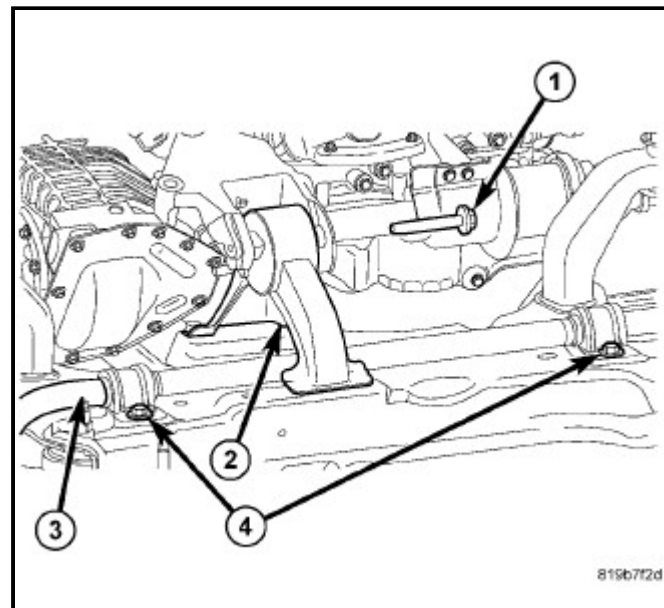

2. Position rear mount bracket on transaxle and install bolts (1). Tighten bolts to 95 N·m (70 ft. lbs.).
3. Tighten rear isolator to suspension crossmember bolts to 61 N·m (45 ft. lbs.).

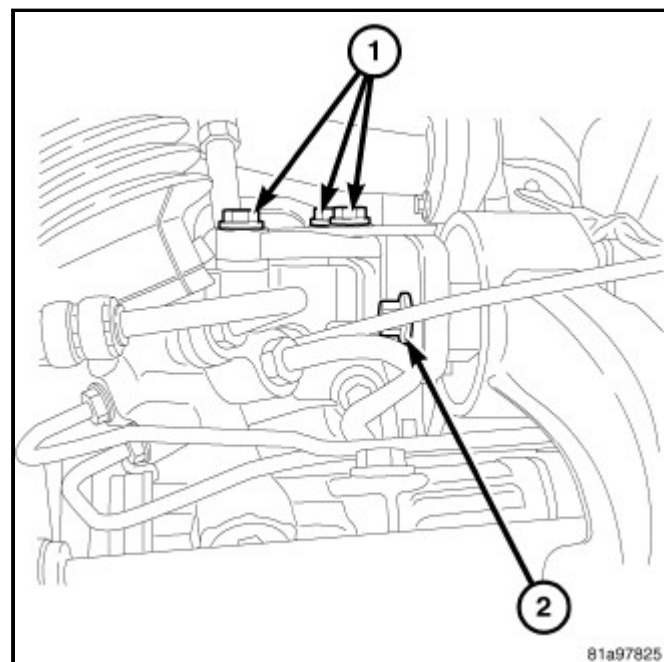

NOTE: Be sure the weight of the engine is static and in rest position.

4. Install rear mount bracket to rear isolator through bolt (1) and tighten to 75 N·m (55 ft. lbs.).

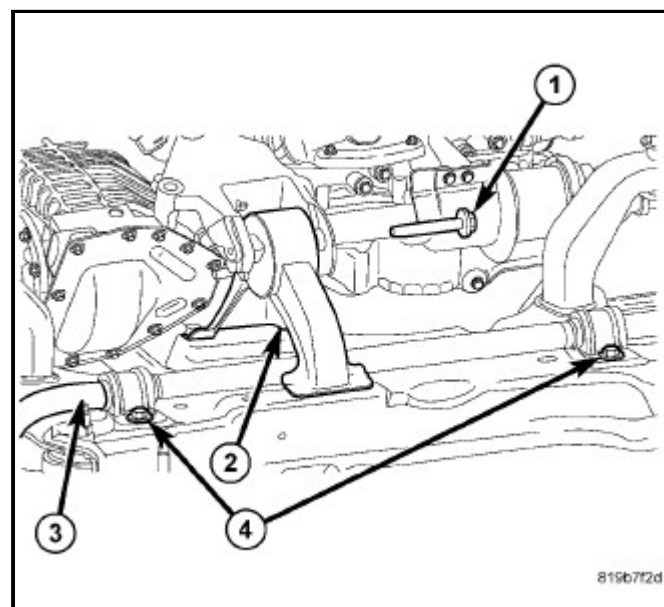

5. Tighten front mount through bolt (2) to 75 N·m (55 ft. lbs.).

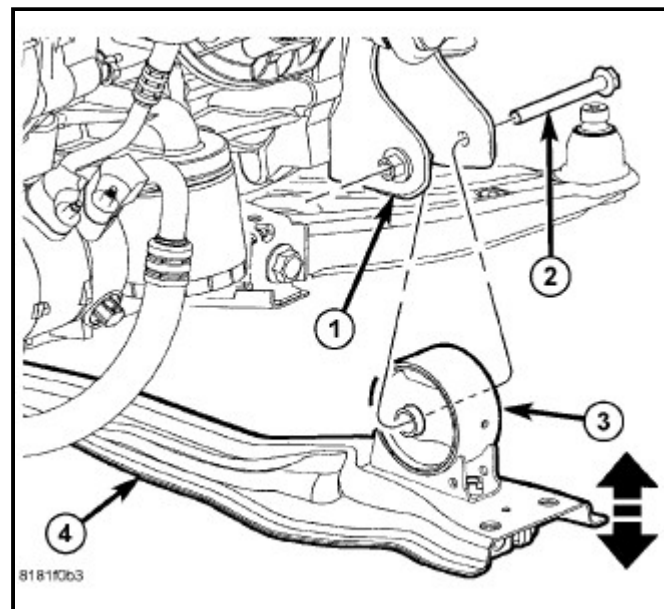

6. Install the belly pan (2).
7. Install throttle body air inlet hose and air cleaner housing assembly ([Refer to 09 - Engine/Air Intake System/BODY, Air Cleaner - Installation](#)).

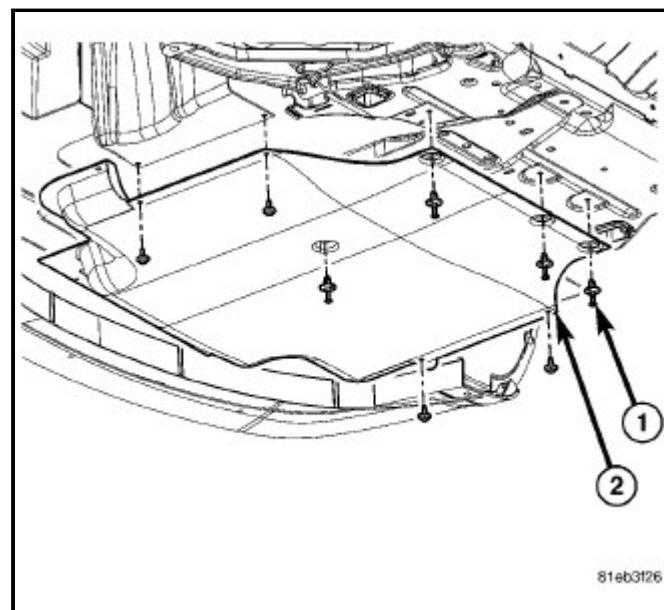

REMOVAL

1. Remove the belly pan (2).

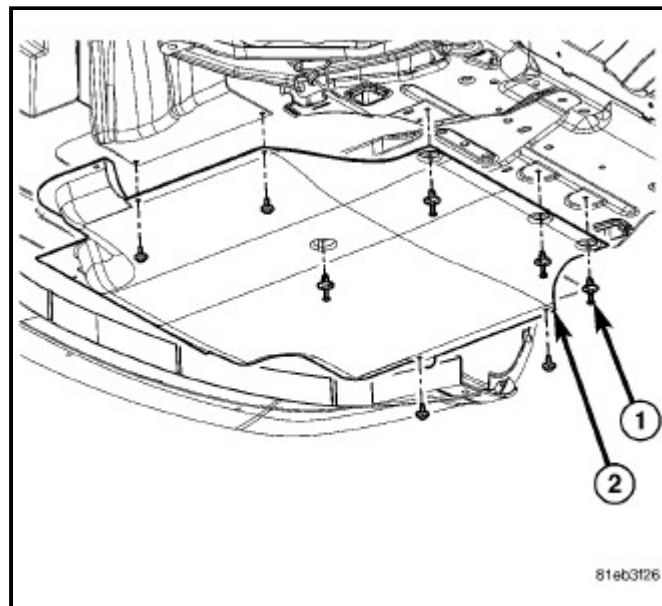

2. Lower vehicle. Remove the load on the engine motor mounts by carefully supporting the engine assembly from below.
3. Remove coolant recovery container ([Refer to 07 - Cooling/Engine/BOTTLE. Coolant Recovery - Removal](#)).
4. Disconnect the ground strap.
5. Remove the right engine support bracket vertical fasteners (1) and (2) and remove support bracket (3).
6. Remove the bolts (5) attaching the right isolator (4) to the frame rail.
7. Remove right isolator (4).

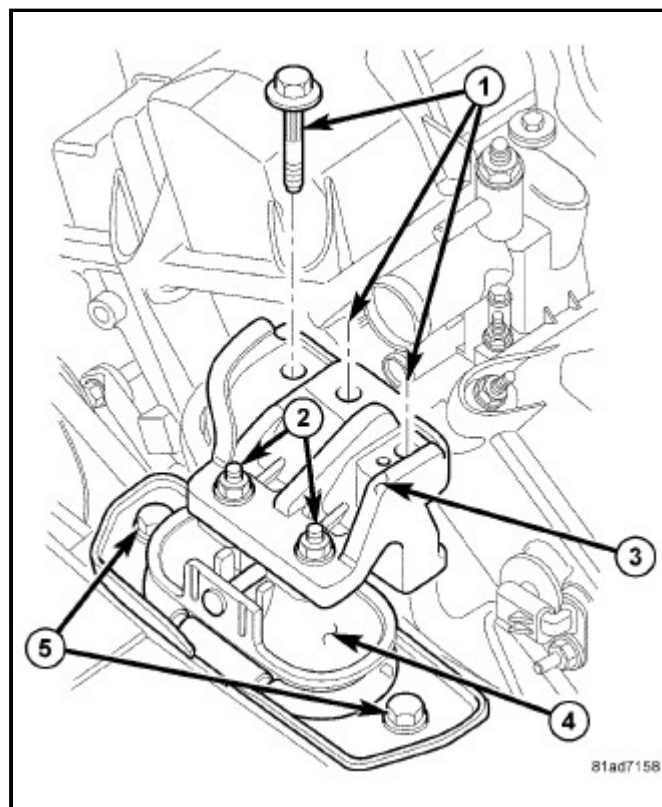

INSTALLATION

1. Position right isolator (4) and install the isolator to frame rail bolts (5). Tighten bolts to 55 N·m (40 ft. lbs.).
2. Install the engine support bracket (3) and bolts (1). Tighten bolts to 50 N·m (37 ft. lbs).
3. Install the support bracket to isolator nuts (2) and tighten to 30 N·m (22 ft. lbs).
4. Reconnect the ground strap.

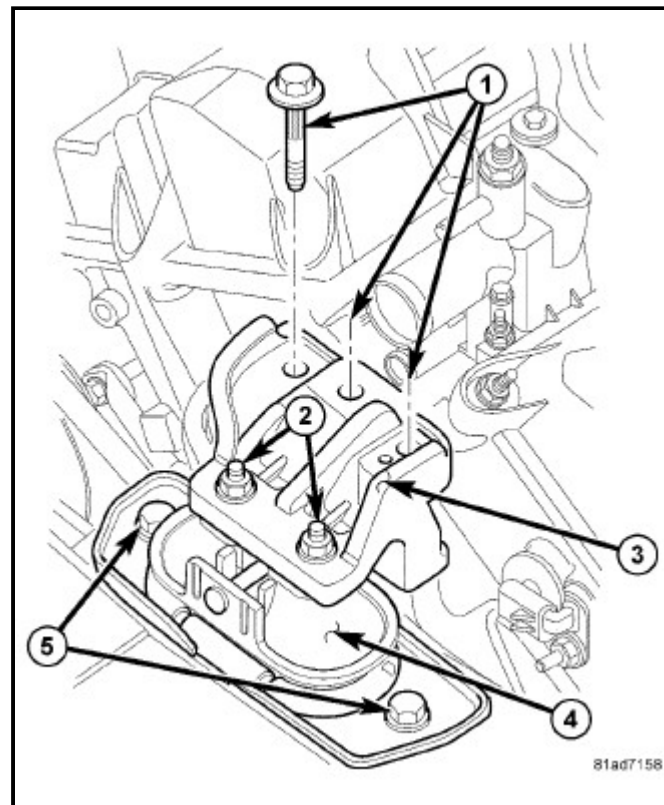

5. Raise vehicle on a hoist.
6. Install the belly pan (2).
7. Install coolant recovery container ([Refer to 07 - Cooling/Engine/BOTTLE, Coolant Recovery - Installation](#)).

